

ADB-L1 Automatic Drill, Point & Broach Machine

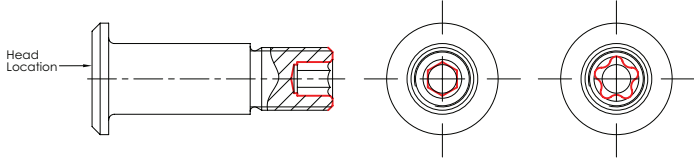

Key Points

- Drilling, pointing, facing and broaching with petal removal
- 1000 - 1500 parts per hour
- All spindles have servo motor drive and servo in-feed
- Broaching with servo-controlled roller screw
- Servo-controlled indexing
- No hydraulics

Features

- Stations
 - 1: Load
 - 2: Centre Drill
 - 3: Drill
 - 4: 2nd Drill
 - 5: Point & face
 - 6: 2,000kgf Servo-controlled broach
 - 7: Drill petals
 - 8: Air blast to remove petals
 - 9: Air blast to clean locations
 - 10: Eject
- Full programmable control of all axes
- Independent control of all cutting speeds and feeds
- Pre-settable tool-holders

Typical Size Range

Larger parts are also possible.

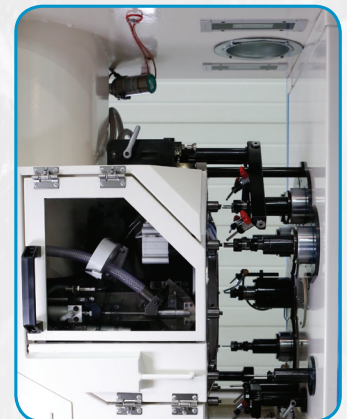
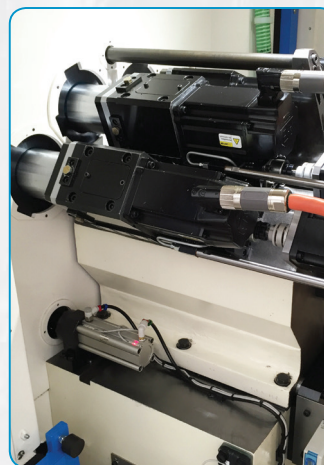
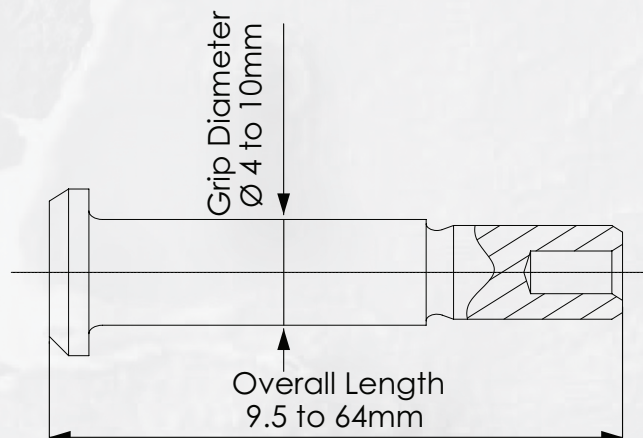

V1/1016

Earlsdon Technology Ltd

Unit 11, Spitfire Close, Coventry, CV5 6UR, England
T: +44 (0) 24 7671 7023
sales@e-tech.co.uk | www.e-tech.co.uk



sales@truformequipment.com | www.truformequipment.com

Truform Equipment Inc.

14744 S. McKinley Avenue, Posen, IL 60469
T: 708-897-8595 F: 708-897-8591

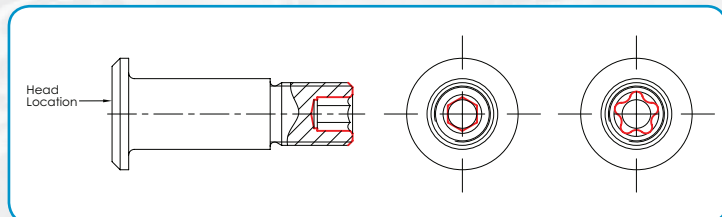

Key Points

- Drilling, Pointing, Facing and Broaching of Aerospace Fasteners
- A fast, flexible, reliable machine specially designed for the job
- 800 – 1400 parts per hour depending on size
- Fast changeover
- Safe, clean working and easy maintenance
- 35 E-Tech Drill / Broach machines running on customers' sites

Features

- 18" dia Vibratory Bowl Feeder
- Indexing Disk with locations to suit 5 different diameters (Indexing Disks can easily be changed)
- 5 stations:
 1. Load
 2. Center Drill / Point & Face
 3. Drill
 4. Broach Hex
 5. Unload
- 2 Rotating spindles with independent variable speed up to 6000 rpm
- Hydraulic Feed-rate Control
- Quick-change pre-settable tooling
- Allen Bradley or Siemens PLC control system with 6" touch-screen (HMI)
- Automatic tool breakage detectors

Size Range

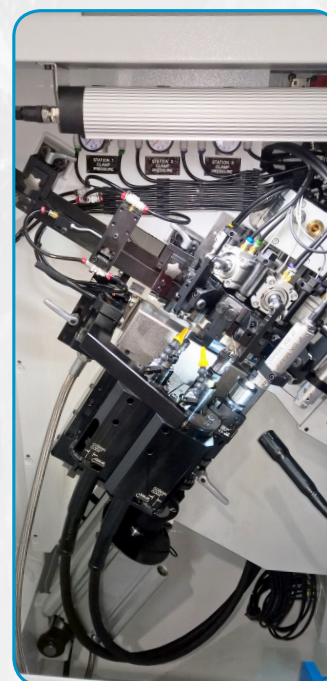
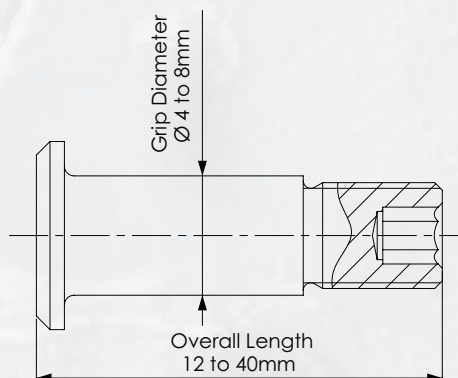

V1/1016

Earlsdon Technology Ltd
Unit 11, Spitfire Close, Coventry, CV5 6UR, Angleterre
Tél. : +44 (0) 24 7671 7023
sales@e-tech.co.uk | www.e-tech.co.uk



Truform Equipment Inc.
14744 S. McKinley Avenue, Posen, IL 60469
T: 708-897-8595 F: 708-897-8591
sales@truformequipment.com | www.truformequipment.com

FR-FX4 Fillet Rolling Machine Single Head Automatic

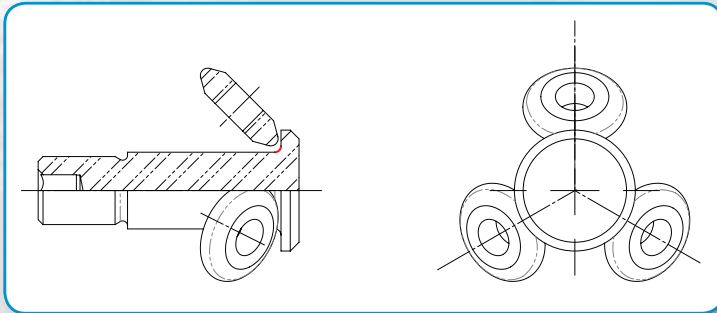

Key Points

- Rolling the underhead radius of Aerospace Fasteners
- 800 - 1500 parts per hour depending on size
- Precise, programmable rolling parameters with 100% in-process checking.
- Fast changeover
- Safe, clean working and easy maintenance
- Giving your customers 100% confidence

Features

- Load cell to measure actual rolling force during each cycle and to check that it is within programmed limits
- Programmable control of rolling force, rpm & time
- Pneumatic cylinder producing up to 1,000kg rolling force
- Drive unit with inverter controlled spindle motor
- 18" dia (450 mm) Vibratory Bowl Feeder
- 'Air-mover' system to deliver parts into machine
- Fast pneumatically-actuated loading system
- Allen Bradley or Siemens PLC control system with 6" touch-screen (HMI)
- Integrated coolant tank, filter and pump

Size Range

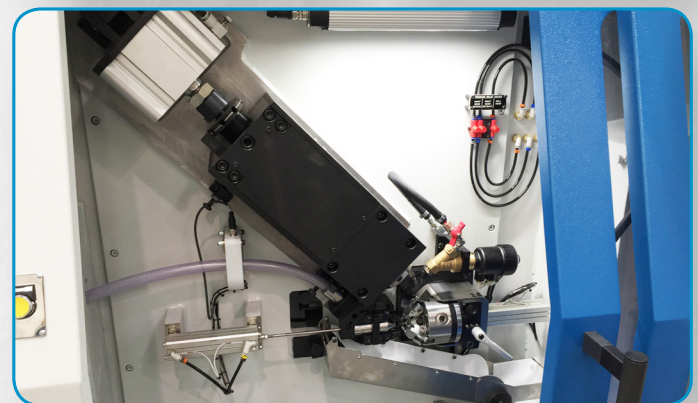
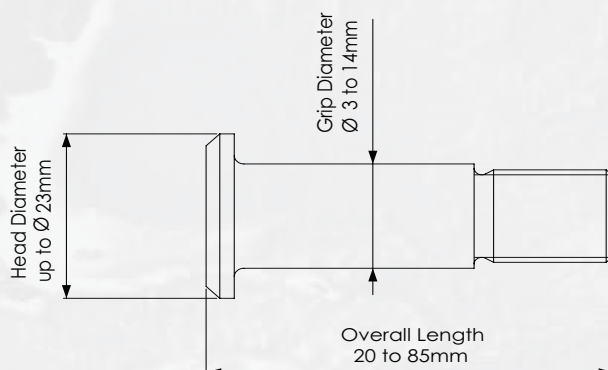

V1/1016

Earlsdon Technology Ltd

Unit 11, Spitfire Close, Coventry, CV5 6UR, England
T: +44 (0) 24 7671 7023
sales@e-tech.co.uk | www.e-tech.co.uk



Truform Equipment Inc.
14744 S. McKinley Avenue, Posen, IL 60469
T: 708-897-8595 F: 708-897-8591
sales@truformequipment.com | www.truformequipment.com

FR-H3 Fillet Rolling Machine Heavy-Duty Semi-Automatic

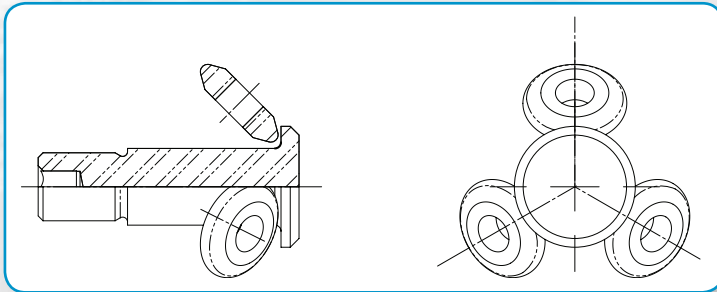

Key Points

- Rolling the underhead radius of Aerospace Fasteners
- 200 - 1000 parts per hour depending on size
- Precise, programmable rolling parameters with 100% in-process checking
- Fast changeover
- Safe, clean working
- Ease of maintenance
- Giving your customers 100% confidence

Features

- Free-standing machine designed to be at a comfortable height for a seated operator
- Manual load and unload
- Automatic cycle initiated by two-hand safety switches
- Safety light curtain to protect operator during cycle
- Load cell to measure actual rolling force during each cycle and to check that it is within programmed limits
- Programmable control of rolling force, rpm & time
- Drive unit with inverter controlled spindle motor
- Allen Bradley or Siemens PLC control system with 6" touch-screen (HMI)
- Integrated coolant tank, filter and pump
- Lockable tool tray

Size Range

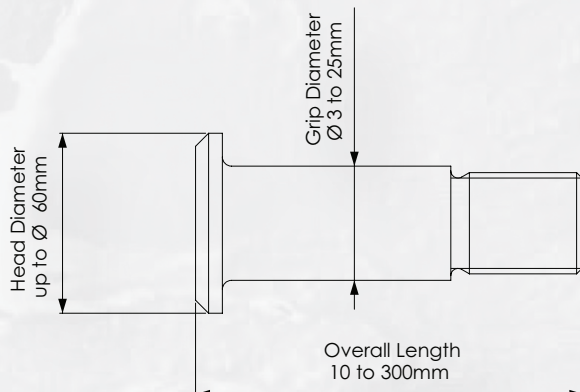

V1/1016

Earlsdon Technology Ltd

Unit 11, Spitfire Close, Coventry, CV5 6UR, England
T: +44 (0) 24 7671 7023
sales@e-tech.co.uk | www.e-tech.co.uk



Truform Equipment Inc.
14744 S. McKinley Avenue, Posen, IL 60469
T: 708-897-8595 F: 708-897-8591
sales@truformequipment.com | www.truformequipment.com

FRH-A2 Fillet Rolling Machine Heavy-Duty Automatic

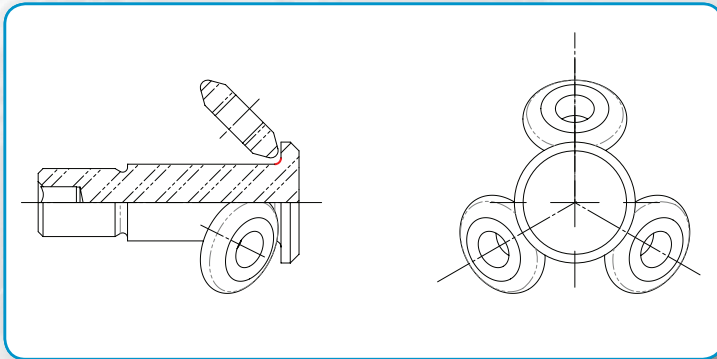

Key Points

- Rolling the underhead radius of Aerospace Fasteners
- 2 Modes: Fully automatic loading or Semi-automatic loading
- Fully-automatic mode – Approximately 400 parts per hour
- Semi-automatic mode 200 - 1000 parts per hour depending on size
- Precise, programmable rolling parameters with 100% in-process checking
- Fast changeover
- Safe, clean working
- Easy maintenance
- Giving your customers 100% confidence

Features

- 24" / 600 mm Ø Vibratory Bowl Feeder
- Servo-controlled Loading Arm
- Load cell to measure actual rolling force during each cycle and to check that it is within programmed limits
- Programmable control of rolling force, rpm & time
- Drive unit with inverter controlled spindle motor
- Allen Bradley or Siemens PLC control system with touch-screen HMI
- Integrated coolant tank, filter and pump
- Lockable tool tray

Semi-automatic Mode (Manual Loading):

- Manual loading cycle initiated by touch sensitive two-hand safety buttons
- Safety light curtain to protect operator during cycle

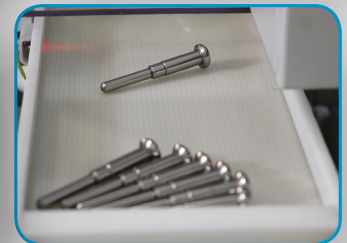
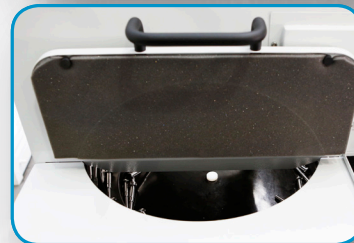
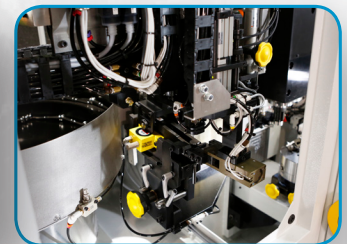
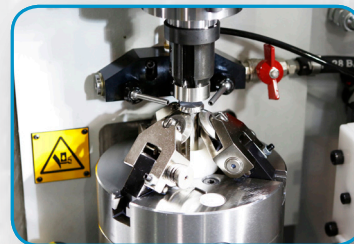

Size Range

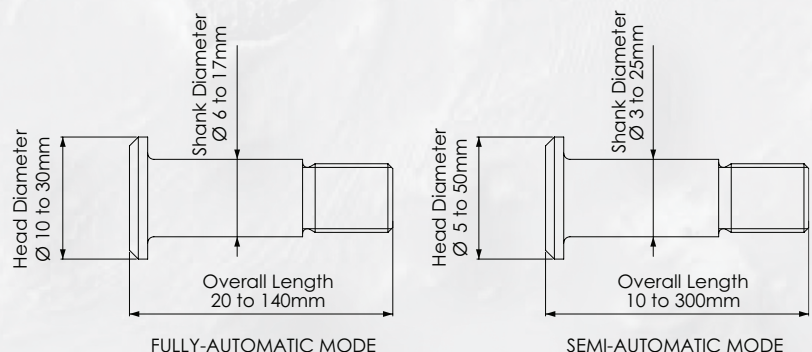

V1/1016

Earlsdon Technology Ltd

Unit 11, Spitfire Close, Coventry, CV5 6UR, England
T: +44 (0) 24 7671 7023
sales@e-tech.co.uk | www.e-tech.co.uk



Truform Equipment Inc.
14744 S. McKinley Avenue, Posen, IL 60469
T: 708-897-8595 F: 708-897-8591
sales@truformequipment.com | www.truformequipment.com

Key Points

- 2 roller machine
- Output up to 3,600 parts per hour
- 100% in-process control of quality
- 100% Monitoring of Rolling Force, Rolling Time and Roller Rotation
- Fully Programmable
- Minimal coolant use. No coolant splash or mist
- Very small footprint (Approximately 1m x 1m (3' x 3'))
- Fast changeover
- Gives your customers 100% confidence

Features

- 15" / 350 mm Ø Vibratory Bowl Feeder
- Up to 400 kgf / 880 lbf Rolling Force
- Load cell integrated into spindle to measure actual rolling force
- Programmable control of rolling force, rpm and time
- Servo controlled spindle motor
- Allen Bradley or Siemens PLC control system with touch-screen HMI
- 3G / Ethernet modem for remote access
- Integrated coolant tank, filter and pump
- Lockable tool tray

Size Range

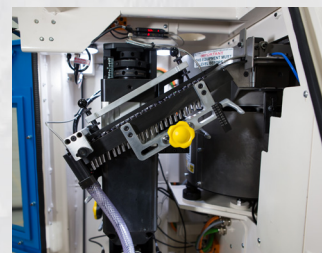
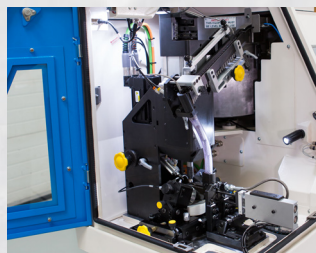
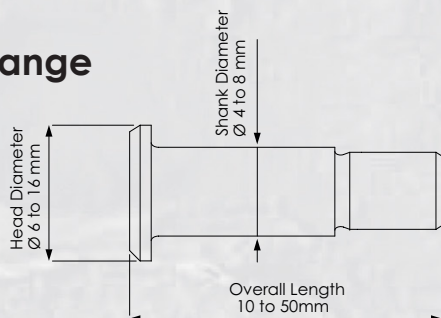

Earlsdon Technology Ltd

Unit 11, Spitfire Close, Coventry, CV5 6UR, England
T: +44 (0) 24 7671 7023
sales@e-tech.co.uk | www.e-tech.co.uk

Truform Equipment Inc.

14744 S. McKinley Avenue, Posen, IL 60469
T: 708-897-8595 F: 708-897-8591
sales@truformequipment.com | www.truformequipment.com

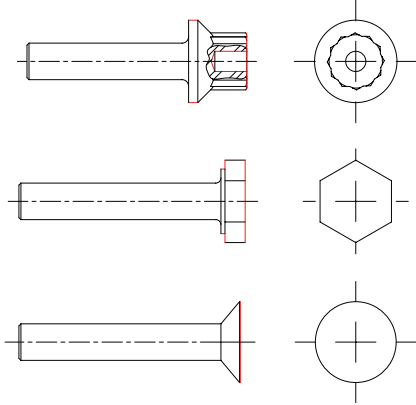

Key Points

- Head turn and drill on one machine
- Facing and chamfering
- Drilling of axial holes

Features

- Siemens 840D sl CNC control
- Easy to learn customised graphical interface
- Heidenhain linear encoders on X and Z axes
- Fast pneumatic loading system
- 5-station gang tooling plate
- Tools with standard indexable inserts
- Pre-settable drill holders

Options available include an integrated swarf conveyor and automatic crash detection system.

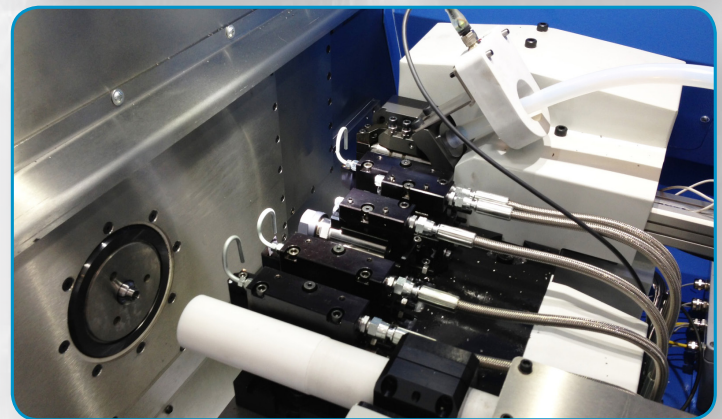
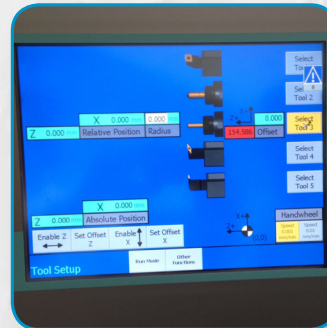

Size Range

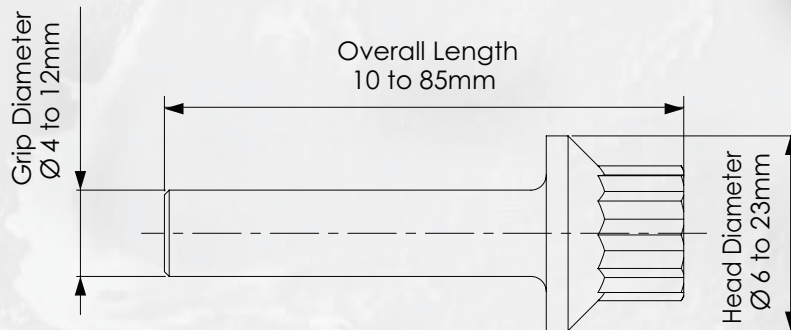

Automatic Loading

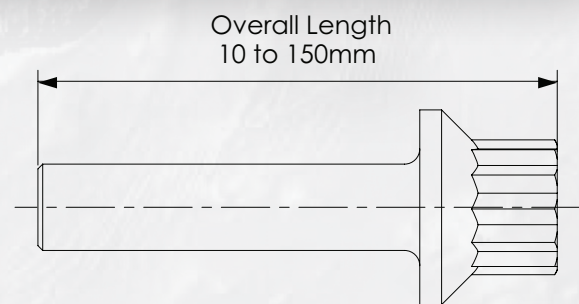

Manual Loading

V1/1016

Earlsdon Technology Ltd
Unit 11, Spitfire Close, Coventry, CV5 6UR, England
T: +44 (0) 24 7671 7023
sales@e-tech.co.uk | www.e-tech.co.uk



Truform Equipment Inc.
14744 S. McKinley Avenue, Posen, IL 60469
T: 708-897-8595 F: 708-897-8591
sales@truformequipment.com | www.truformequipment.com

RT-X1 Drilling, Reaming & Tapping Machine

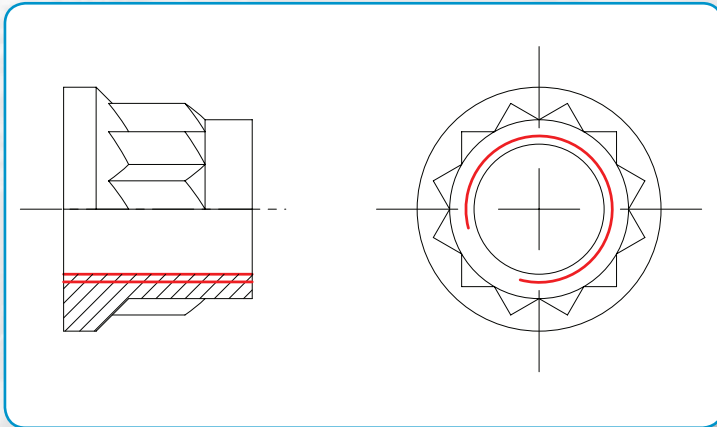

Key Points

- Fast changeover
- Servo controlled tapping heads
- Change thread pitches with a touch of a button
- Safe, clean working
- Ease of maintenance
- Giving your customers 100% confidence

Features

- Reaming and tapping 2 different nut sizes simultaneously
- Production rates up to 24 parts per minute.
- Customised touch-screen operator control.
- Tool wear monitoring by measurement of spindle current
- Quick Changeover
- Automatic removal of swarf from parts
- Allen Bradley or Siemens PLC control system with 6" touch-screen (HMI)
- Lockable tool tray
- 6 stations x 2
 - Load
 - Ream
 - Tap
 - Spare Station for Changing Tooling
 - Clear Swarf and Unload
 - Automatic Cleaning of Tooling

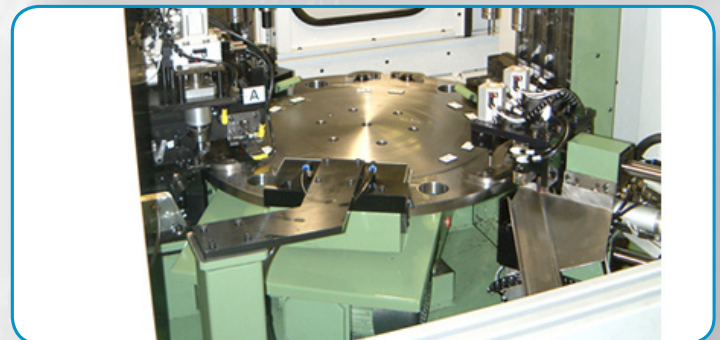

V1/1016

Earlsdon Technology Ltd

Unit 11, Spitfire Close, Coventry, CV5 6UR, England
T: +44 (0) 24 7671 7023
sales@e-tech.co.uk | www.e-tech.co.uk



Truform Equipment Inc.
14744 S. McKinley Avenue, Posen, IL 60469
T: 708-897-8595 F: 708-897-8591
sales@truformequipment.com | www.truformequipment.com

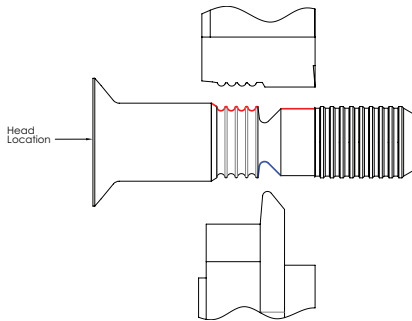

Key Points

- Turning Lock Grooves, Break-neck and Rollback Land on Titanium Aerospace Lock-Bolts
- Fully programmable servo control
- Cycle Time: < 3 seconds
- Quick Changeover

Features

- Two servo-controlled slides working simultaneously
- Absolute Linear Encoders on both slides
- High-precision 5kW 5,000 rpm servo-driven spindle
- New fast automatic loading
- Siemens or Allen Bradley control
- 8" colour touch-screen HMI
- Specially-written user-friendly software in multiple languages
- 3G / Ethernet Modem for remote access
- Fire Suppression system

Size Range

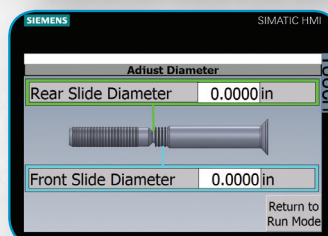
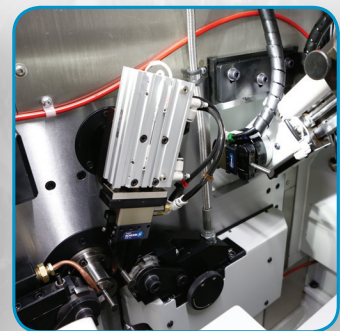
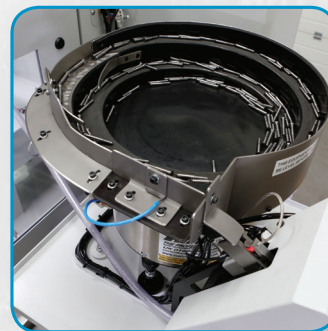
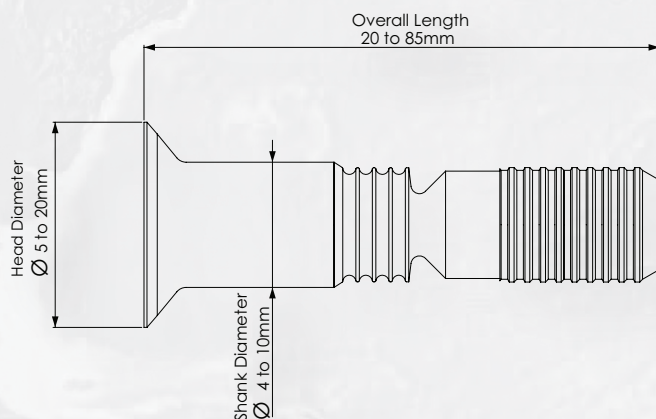

V1/1016

Earlsdon Technology Ltd
Unit 11, Spitfire Close, Coventry, CV5 6UR, Angleterre
Tél. : +44 (0) 24 7671 7023
sales@e-tech.co.uk | www.e-tech.co.uk



Truform Equipment Inc.
14744 S. McKinley Avenue, Posen, IL 60469
T: 708-897-8595 F: 708-897-8591
sales@truformequipment.com | www.truformequipment.com